

JUMPER Pulse Oximeter JPD-500E User Manual

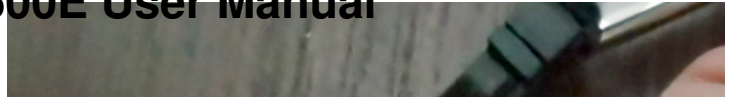

[Home](#) » [JUMPER](#) » JUMPER Pulse Oximeter JPD-500E User Manual

Contents [[hide](#)]

- [1 JUMPER Pulse Oximeter JPD-500E](#)
- [2 Safety](#)
- [3 Overview](#)
- [4 Principle and Caution](#)
- [5 Accessories](#)
- [6 Installation](#)
 - [6.1 View of the Front panel](#)
 - [6.2 Battery](#)
- [7 Operating Guide](#)
- [8 Repairing and Maintenance & cleaning and disinfection](#)
- [9 Troubleshooting](#)
- [10 Technical Specification](#)
- [11 Warranty](#)
- [12 Documents / Resources](#)
 - [12.1 References](#)
- [13 Related Posts](#)

JUMPER

JUMPER Pulse Oximeter JPD-500E



Dear users, thank you very much for purchasing the Pulse Oximeter.

This Manual is written and compiled in accordance with the council directive MDD 93/42/EEC for medical devices and harmonized standards. In case of modifications and software upgrades, the information contained in this document is subject to change without notice.

Please read the User Manual carefully before using this product.

WARNING:

- Uncomfortable or painful feeling may appear if using the device ceaselessly, especially for the microcirculation barrier patient. It is recommended that the sensor should not be applied to the same finger for over 2 hours.
- The light (the infrared is invisible) emitted from the device is harmful to the eyes, so the user and the maintenance man should not stare at the light.
- Enamel or Acrylic fingernail polish or other fingernail applications may distort and/or produce inaccurate readings.
- Please refer to the correlative literature about the clinical restrictions and caution.
- This device is not intended for treatment.

Safety

Instructions for Safe Operations

- Check the main unit and all accessories periodically to make sure that there is no visible damage that may affect patient's safety and monitoring performance about cable and transducers. It is recommended that the device should be inspected once a week at least. When there is obvious damage, stop using the monitor.
- Necessary maintenance must be performed by qualified service engineers ONLY. Users are not permitted to maintain it by themselves.

- The oximeter cannot be used together with devices not specified in User Manual. Only the accessory that appointed or recommendatory by manufacture can be used with this device.
- This product is calibrated before leaving factory.

Warning

- Explosive hazard—DO NOT use the oximeter in environment with inflammable gas such as some ignitable anesthetic agents.
- DO NOT use the oximeter while the user is measured by MRI and CT.
- The person who is allergic to rubber can not use this device.
- The disposal of scrap instrument and its accessories and packing (including battery, plastic bags, foams and paper boxes) should follow the local laws and regulations.
- Please check the packing before use to make sure the device and accessories are totally in accordance with the packing list, or else the device may have the possibility of working abnormally.

Attentions

- Keep the oximeter away from dust, vibration, corrosive substances, explosive materials, high temperature and moisture.
- If the oximeter gets wet, please stop operating it.
- When it is carried from cold environment to warm or humid environment, please do not use it immediately.
- High temperature or high pressure steam disinfection of the oximeter is not permitted. Refer to User Manual in the relative chapter for instructions of cleaning and disinfection.
- Do not have the oximeter immersed in liquid. When it needs cleaning, please wipe its surface with medical alcohol by soft material. Do not spray any liquid on the device directly.
- Do not use the device on infant or neonatal patients.
- The product is suitable for children above four years old and adults(Weight should be between 15kg to 110kg).
- The device may not work for all patients. If you are unable to achieve stable readings, discontinue use.
- The update period of data is less than 5 seconds, which is changeable according to different individual pulse rate.
- The instrument does not have low-voltage alarm function, it only shows the low-voltage, please change the battery when the battery energy is used out.
- Batteries must be removed if the device is going to be stored for more than once month, or else batteries may leak.

Indication for use

The Fingertip Pulse Oximeter is a non-invasive device intended for the spot-check of oxygen saturation of arterial hemoglobin (SpO₂) and the pulse rate of adult and pediatric patients in home and hospital environments (including clinical use in internist/surgery, anesthesia, intensive care etc.). This device is not intended for continuous monitoring.

Overview

The pulse oxygen saturation is the percentage of HbO₂ in the total Hb in the blood, so-called the O₂

concentration in the blood. It is an important bio-parameter for the respiration. For the purpose of measuring the SpO₂ more easily and accurately, our company developed the Pulse Oximeter. At the same time, the device can measure the pulse rate simultaneously. The Pulse Oximeter features in small volume, low power consumption, convenient operation and being portable. It is only necessary for patient to put one of his fingers into a fingertip photoelectric sensor for diagnosis, and a display screen will directly show measured valued of Hemoglobin Saturation.

Classification:

Class II a (MDD 93/42/EEC IX Rule 10)

Class II (U.S.FDA)

Feature

- Operation of the product is simple and convenient.
- The product is small in volume, light in weight (total weight is about 50g including batteries) and convenient in carrying.
- Power consumption of the product is low .
- The product will automatically be powered off when no signal is in the product within 16 seconds.

Major Applications and Scope of Application

The Pulse Oximeter can be used to measure human Hemoglobin Saturation and pulse rate through finger, and indicate the pulse intensity by the bar-display. The product is suitable for use in family, hospital (Ordinary sickroom), Oxygen Bar, social medical organizations and also the measure of saturation oxygen and pulse rate.

The product is not suitable for use in continuous supervision for patients.

Environment Requirements

Operation Temperature: 5°C-40°C

Storage Temperature: -10°C-50°C

Ambient Humidity: 15%-80% RH, no condensation in operation 10%-93% RH, no condensation in storage

Atmospheric Pressure: 70 kPa to 106 kPa, in operation 50kPa–106 kPa, in storage

Principle and Caution

Principle of Measurement

Principle of the Oximeter is as follow: An experience formula of data process is established taking use of Lambert Beer Law according to Spectrum Absorption Characteristics of Reductive Hemoglobin (Hb) and Oxyhemoglobin (HbO₂) in glow & near-infrared zones. Operation principle of the instrument is : Photoelectric Oxyhemoglobin inspection Technology is adopted in accordance with Capacity Pulse Scanning & Recording Technology, so that two beams of different wavelength of lights can be focused onto human fingertip through perspective clamp finger-type sensor. Then measured signal can be obtained by a photosensitive element, information acquired through which will be show on screen through treatment in electronic circuits and microprocessor.

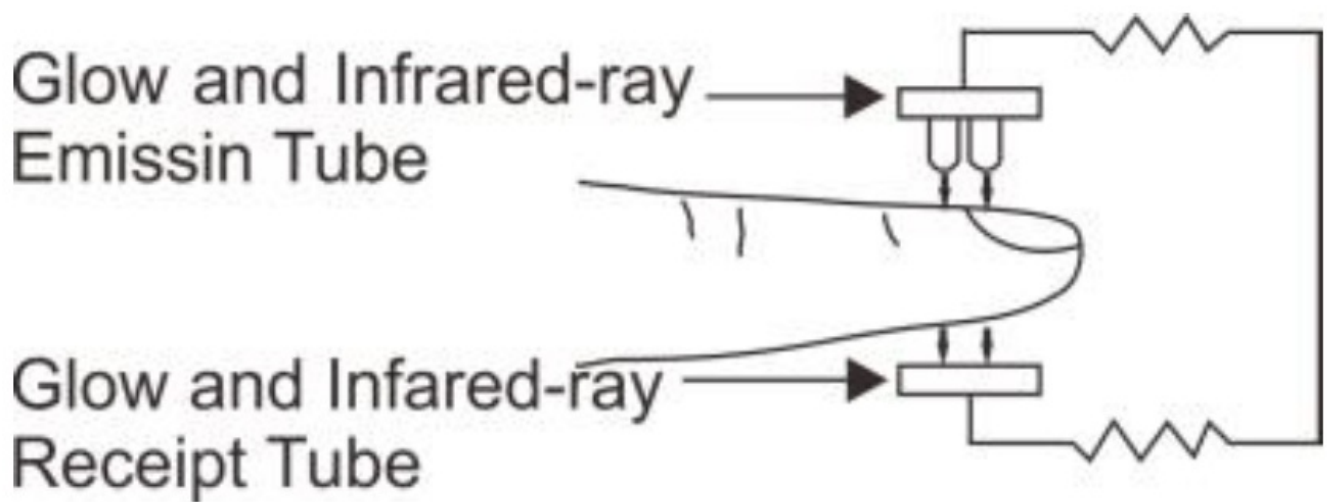

Figure 1 Operating principle

Caution

1. The finger should be placed properly (see the attached illustration of this manual, Figure 5), or else it may cause inaccurate measurement.
2. The SpO2 sensor and photoelectric receiving tube should be arranged in a way with the subject's arteriole in a position there between.
3. Excessive ambient light may affect the measuring result. It includes fluorescent lamp, dual ruby light, infrared heater, direct sunlight and etc.
4. Strenuous action of the subject or extreme electro-surgical interference may also affect the accuracy.

Accessories

1. One hanging rope;
2. Storage bag; Two AAA batteries;
3. One user's manual;

Installation

View of the Front panel

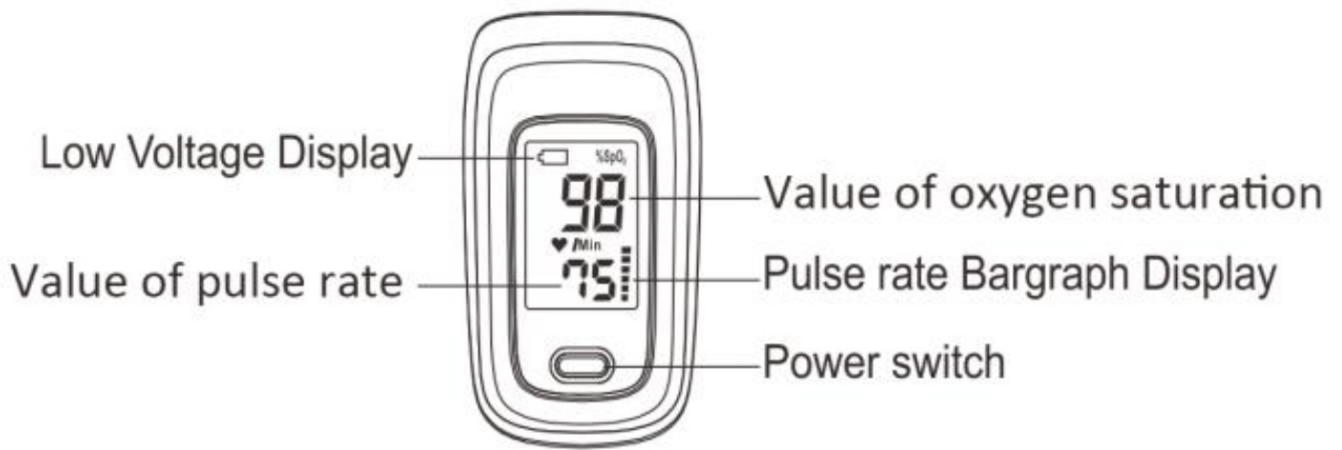

Figure 2. Front View

Battery

Step 1. Refer to Figure 3. and insert the two AAA size batteries properly in the right direction.

Step 2. Replace the cover.

Please take care when you insert the batteries for the improper

insertion may damage the device.

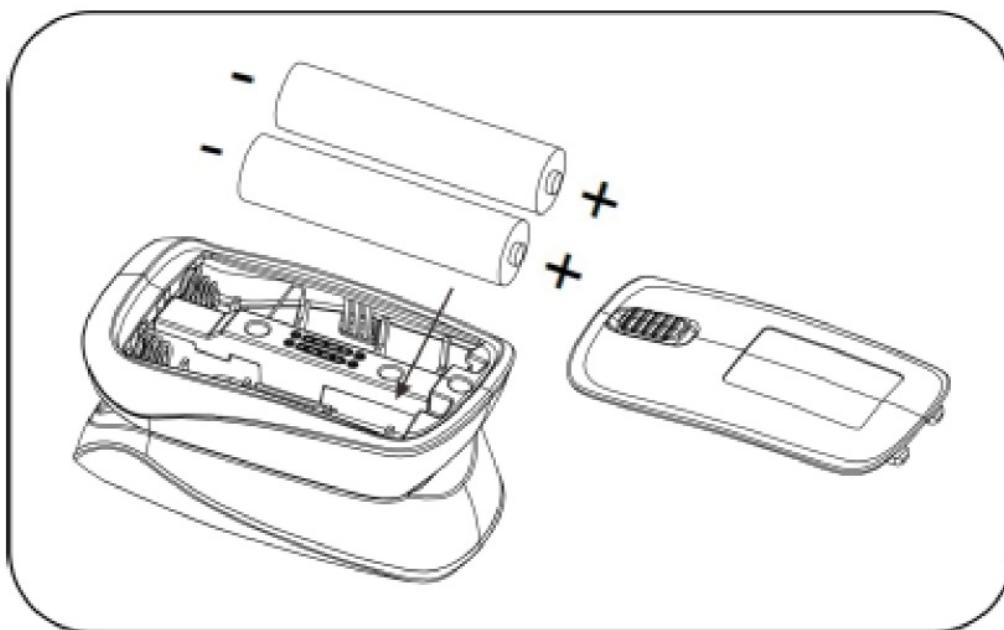

Figure 3. Batteries Installation

Step 2. Put another end of the rope through the first one and then tighten it.



Figure 4. Mounting the hanging rope

Operating Guide

1. Insert the two batteries properly to the direction, and then replace the cover.
2. Open the clip as shown in Figure 5.



Figure 5. Put finger in position

3. Let the patient's finger put into the rubber cushions of the clip (make sure the finger is in the right position), and then clip the finger.
4. Press the switch button once on front panel.
5. Do not shake the finger and keep the patient at ease during the process. Meanwhile, human body is not recommended in movement status.
6. Get the information directly from screen display.
7. In boot-strap state, press button, and the device is reset.

Fingernails and the luminescent tube should be the same side.

Repairing and Maintenance & cleaning and disinfection

- Please change the batteries when the low-voltage display on the screen.

- Please clean the surface of the device before using. Wipe the device with medical alcohol first, and then let it dry in air or clean it by dry clean fabric.
- Using the medical alcohol to disinfect the product after use, prevent from cross infection for next time use.
- Please take out the batteries if the oximeter is not use for a long time. Warning: High-pressure sterilization cannot be used on the device. Warning: Do not immerse the device in liquid.

Warning: It is recommended that the device should be kept in a dry environment. Humidity may reduce the useful life of the device, or even damage it.

Troubleshooting

Trouble	Possible Reason	Solution
The SpO2 and Pulse Rate can not be displayed normally	<ol style="list-style-type: none"> 1.The finger is not properly positioned. 2.The patient's SpO2 is too low to be detected. 	<ol style="list-style-type: none"> 1.Place the finger properly and try again. 2.Try again; Go to a hospital for a diagnosis if you are sure the device works all right.
The SpO2 and Pulse Rate are not displayed stably	<ol style="list-style-type: none"> 1.The finger is not placed inside deep enough. 2.The finger is shaking or the patient is moving. 	<ol style="list-style-type: none"> 1.Place the finger properly and try again. 2.Let the patient keep calm
The device can not be turned on	<ol style="list-style-type: none"> 1.Low battery or no battery. 2.The batteries are not inserted properly. 3.The malfunction of the device. 	<ol style="list-style-type: none"> 1.Change batteries. 2.Reinstall batteries. 3.Please contact the local service center.
The display is off suddenly	<ol style="list-style-type: none"> 1.The device will power off automatically when there is no signal within 16 seconds. 2.The batteries are almost drained. 	<ol style="list-style-type: none"> 1.Normal. 2.Change batteries.

Key of Symbols

Symbol	Description
	Type BF applied part
	Caution: Please see this manual.
%SpO2	Symbol of oxygen saturation.
bpmPR	Symbol of pulse rate.
	No SpO2 alarms.
	Consult the instructions for use.
IP22	The degree of protection against harmful ingress of water and particulate matter.
	When end users abandon this product, they must send the product to the collection place for recycling.

Technical Specification

Display Information	Display Mode
Display Format	LED display
The Pulse Oxygen Saturation (SpO2)	Digital
Pulse Rate (PR)	Digital
Pulse Intensity (bar-graph)	Digital bar-graph display
SpO2 Parameter Specification	
Measuring range	35%-100% (the resolution is 1%).
Accuracy	70%-100%;±2%, Below 70% unspecified.
Pulse Parameter Specification	

Measuring range	25bpm-250bpm (the resolution is 1 bpm)
Accuracy	±2bpm
Pulse Intensity	
Range	Continuous bar-graph display, the higher display indicates the stronger pulse.
Alert conditions	
SpO2	Less than 94%
PR	Less than 50bpm or more than 130bpm
Battery Requirement	
2 X 1.5V (AAA size) alkaline battery	
Power Consumption	
Smaller than 35 mA.	
Battery Useful Life	
Two batteries can work continually for 24 hours	
Power off	
The Oximeter can be powered off in case no finger is the Oximeter within 16 seconds.	

Optical Sensor	
Red light (wavelength is 660nm) Infrared (wavelength is 905nm)	
Dimensions and Weight	
Dimensions	62 (L)X37 (W)X32(H) mm
Weight	About 50g (with the batteries)
Manufacturing date: see the label	

Appendix: Electromagnetism Compatibility

Guidance and manufacture's declaration – electromagnetic emissions-for all EQUIPMENT and SYSTEMS

Guidance and manufacture's declaration – electromagnetic emission		
The <i>JPD-500E</i> is intended for use in the electromagnetic environment specified below. The customer of the use r of the <i>JPD-500E</i> should assure that it is used in such and environment.		
Emission test	Compliance	Electromagnetic environment – guidance
RF emissions CISPR 11	Group 1	The <i>JPD-500E</i> uses RF energy only for its internal function. Therefore, its RF emissions are very low and are not likely to cause any interference in nearby electronic equipment.
RF emission CISPR 11	Class B	The <i>JPD-500E</i> is suitable for use in all establishments, including domestic establishments and those directly connected to the public low-voltage power supply network that supplies buildings used for domestic purposes.

Warranty

Your product is warranted to be free of defects in materials and workmanship for one year from the original purchase date.

The device was built to exacting standards and carefully inspected prior to shipment. In the event of a defect covered by this warranty, we will at option, repair or replace the device.

This warranty does not cover device failure due to owner misuse or negligence, or normal wear and tear. If you have questions about your device, or this warranty, please contact an authorized Jumper Medical provide.

After-sale service unit: Shenzhen Jumper Medical Equipment Co., Ltd. Address: D Building, No. 71, Xintian Road, Fuyong Street, Baoan, Shenzhen,Guangdong,China

Tel: +86-755-26696279

Fax: +86-755-26852025

mail info@jumper-medical.com

Website: www.jumper-medical.com

Postal Code: 518103

JUMPER

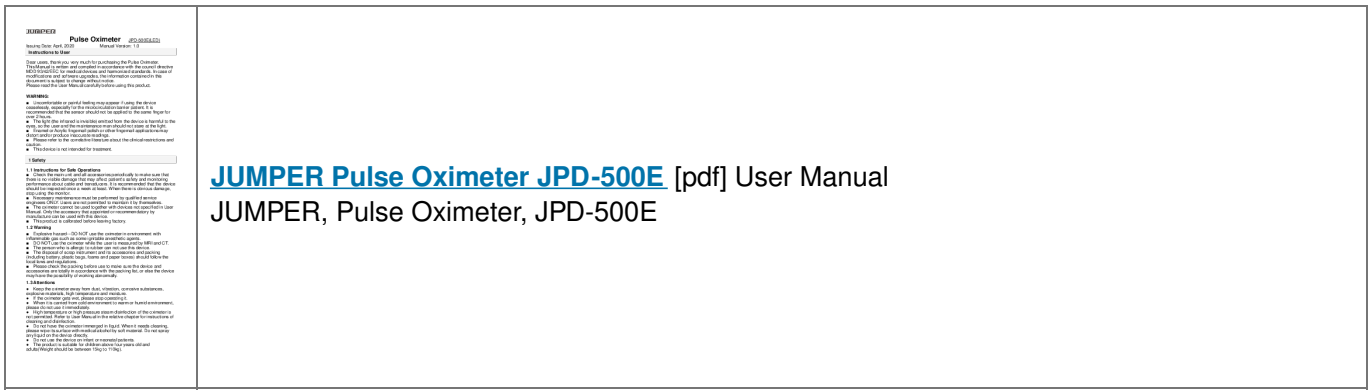

JUMPER Pulse Oximeter JPD-500E [pdf] User Manual
JUMPER, Pulse Oximeter, JPD-500E

References

- [-](#)
- [medical.com is for sale | www.brandforce.com](#)
- [-](#)

Related Posts



[Oxiband 02 Pulse Oximeter User Manual](#)

Oxiband 02 Pulse Oximeter User Manual - Download [optimized] Oxiband 02 Pulse Oximeter User Manual - Download



[JUMPER Pulse Oximeter JPD-500D User Guide](#)

JUMPER Pulse Oximeter JPD-500D User Guide Precautions Do not attempt to maintain the Oximeter unless you are...



[Dr Trust 211 Pulse Oximeter Instruction Manual](#)

211 Pulse Oximeter



[LAVA Pulse User Manual](#)

USER MANUAL Simple steps to measure your Heart Rate/BP: Press the * key on dial pad and unlock...